

# Powder Fire Extinguisher kg 6 Class of fire 34A 233B C

EN3 conformity certificate nr. **DCPREV001680** EC Approved Certificate: **CE-1370-PED-H-ABS001-09-ITA**



**34**  
Organic solid materials,  
wood rubber, textiles etc.



**233**  
Flammable liquids,  
gasoline, oil etc.



**C**  
Flammable gases,  
methane, propane.



## Cylinder

The design cylinder is manufactured according to UNI EN 3-3 and DIR 97/23/EC, the welding process and the welders' qualification is made according to the EN 288 and EN 1418, which require for each batch bursting and crush test at 26 bar.  
The cylinder is made in 3 pieces with two domes (upper and lower) steel type DD12, one cylindrical shell, steel type DD12 and the neck gear steel type S235J2G3.  
The minimum elongation is 17%.  
At about 30 bar begins shell deformation and the burst is always at minimum 60 bar.  
In case of wrong pressurization with a pressure reducer, the great deformation allows to the operator to stop immediately to prevent a fatal accidents.  
The deep drawing cylinder is more elegant and attractive, but has great disadvantage due to zero deformation of cylinder during bursting test.  
During normal pressurization, if a wrong pressure reducer introduce a higher pressure, the cylinder may burst suddenly without any advice and causing serious accident.  
The cylinder is sand blasted with metallic sand and painted with epoxy-polyester powder Red color Ral 3000 resistant to the all weather and to the ultraviolet rays.

## Valve M45x1,5, CE marked ped 97/23

The swivel neck ring M45 guaranteed the correct position of the pressure gauge always opposite to the welding.

## Pressure gauge

Pressure gauge Ø 42 mm. The green area indicates that the extinguisher is pressurized and ready to use, while if the needle is in red area contact your local authorized maintenance agent.

## Discharge hose

Consists of EPDM rubber hose with textile reinforcement. The pipe hose is highly resistant, it remains soft from -30°C to +60°C instead the economic PVC become hard at low temperature.

## Extinguishing agent

Our partners are prestigious companies such us Caldic Furex and Total (Germany), Rull Chemie, certified ISO 9001 with superior quality raw materials, with strict control.  
The basic components of dry powder are monoammonium phosphate 40%, ammonium sulphate 55% and additives which can ensure fluidity, water repellency for over 20 years.



The wall bracket keep the fire extinguisher close to the wall



Foot and bottom manufactured in single pressing process. Bottom will never rust.



## Use

- 1) Pick up the extinguisher from the wall support.
- 2) Pull out the safety pin (2) from the valve and keep in the other hand the hose (12) near the nozzle;
- 3) Squeeze the upper lever of the valve (1) and aim the jet at the base of the burning material, sweep the extinguishing agent right and left uniformly on the fire.

In case of fire of flammable liquids don't approach too much. Service must me at least yearly or according to the local regulations. In some countries training is requested to use the extinguisher.

This extinguisher can be used on all the types of fire classes **A B C** and also on electrical equipment up to 1000 Volt at 1 m distance minimum. In laboratory the extinguisher succeeded the dielectric test at 35 KV at 1 mt distance.

**21162** Schroeder check valve, is locked with safety pin seal.



Safety valve preassembled. Bursting disc fast release. Filter stop powder discharge in case of blow of disc.

**21161**

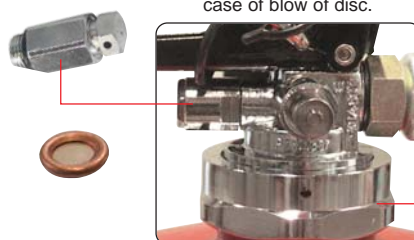

True large bourdon gauge Ø 42 mm not a simple indicator.

**20523** Manometer



**Swivel neck ring**  
Easy positioning

**Technical specifications**

Extinguishing agent.....: powder ABC 40  
 Propellant.....: nitrogen or dry air  
 Nominal charge.....: 6 Kg  
 Discharge time ~.....: 18.5 sec  
 Jet length ~.....: 7 m  
 Operating pressure.....: 14 bar at 20°C  
 Test pressure according 97/23/EC.....: 26 bar

Burst pressure.....: >55 bar  
 Temperature range.....: -30°C +60°C

**Dimensions**

Height ~.....: **610 mm**  
 Width ~.....: **310 mm**  
 Diameter ~.....: **160 mm**  
 Weight ~.....: **10 kg**

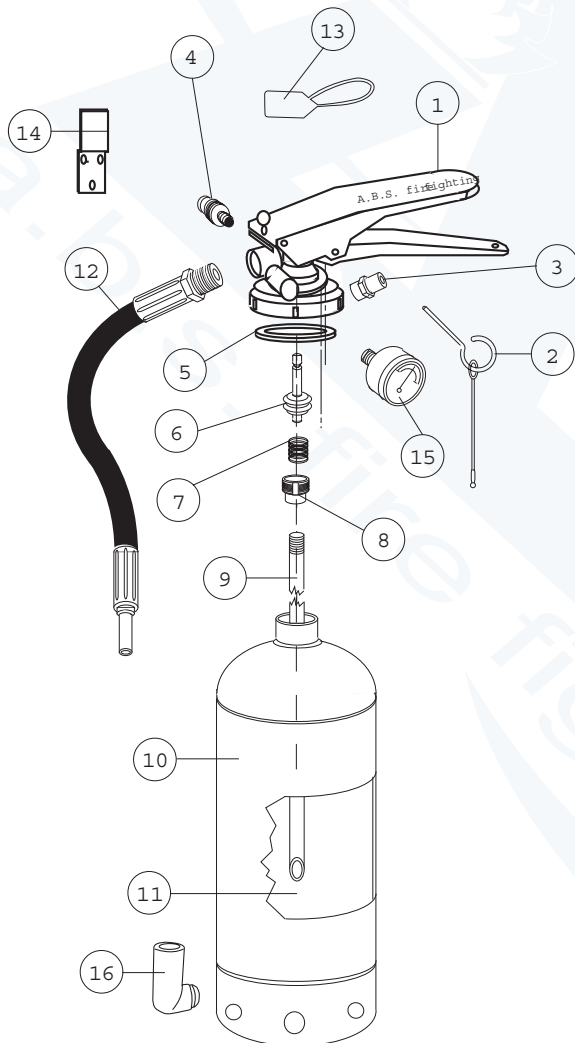

**Spare part list**

Pos.	Description	Code	Q.ty
1	Complete valve	21815	1
2	Safety pin	21018	1
3	Safety valve	21161	1
4	Check valve	21162	1
5	O-ring of valve	21028	1
6	Spindle	21249	1
7	Spring	21094	1
8	Siphon nut	21250	1
9	Siphon tube PVC	21720	1
10	Cylinder (8,4 lt)	27618	1
11	Powder ABC 40	31240	6 kg
12	Discharge hose	21620	1
13	Safety seal	28019	1
14	Extinguisher wall bracket	20052	1
15	Pressure gauge Ø 42	20523	1
16	Hook hose holder	21826	1



EN3/7



Made in Italy

The use of non original spare parts may cause malfunctions loss

**Maintenance and Guarantee**

Maintenance must be made periodically by, trained and certified staff, according to the local regulations of the country where it is located. The extinguisher is guaranteed for 12 months from the date of the supply. The guarantee includes, repairing or replacement, as manufacturer option. Unit must be sent back to the factory free of charge, only when authorized written agreement with our sales office has been reached. The guarantee expires in case of tampering and bad maintenance made by not-authorized staff, or transport damages. It must be recharged only by staff authorized and certified by **a.b.s. S.r.l.**, use only genuine original spare parts.